

AGNI-System №AP-216

Step-by-step installation instructions:

1. Wrap one revolution of a 140mm wide AGNI-Sleeve around each service.
2. Wrap one revolution of a 140mm wide AGNI-Sleeve around the bundle of two lagged pipes.
3. Insert the AGNI-Sleeves into the aperture, finishing 10mm past each lining of the wall.
4. Apply 10mm (nominal) deep AGNI-Black into the gap between the AGNI-Sleeve and the lining from both sides & in all gaps within the bundle.



Technical Information

System ID	AP-216
Substrate	<ul style="list-style-type: none"> • Min. 64mm timber or steel stud wall with a minimum of two layers of 13mm (or greater) FR plasterboard on each side, with or without insulation. • Min. 116mm concrete wall
Service range	32mm Copper Pipe with 32mm thick nitrile rubber insulation + 15mm Copper Pipe with 25mm thick nitrile rubber insulation
Annular gap	7.2 - 14.2mm
AGNI-Products	AGNI-Black, AGNI-Sleeve
Protection installation	From both sides of the wall

Compliance Information

Standards	AS1530.4-2014, AS4072.1-2005
FRR/FRL	-/120/120
Reference	PF25008



8 Clare St Bayswater
VIC 3153, AUSTRALIA
+61 (03) 7045 4242
info@agnitek.com.au
www.agnitek.com.au

Disclaimer

Agnitek reserves the right to modify product specifications without prior notice due to its ongoing research, development & certification programme. The information in this document is provided in good faith and is intended for guidance purposes only. Any accompanying drawings are solely for illustrative purposes. Since Agnitek cannot oversee installation methods or ensure site conditions, no warranties, expressed or implied, are intended regarding the products' actual performance. We do not accept liability for any loss, damage, or injury from using this information. Please take a look at the test reports displayed on a relevant AGNI-System webpage for all compliance specifics.

Date	12.05.2025
------	------------

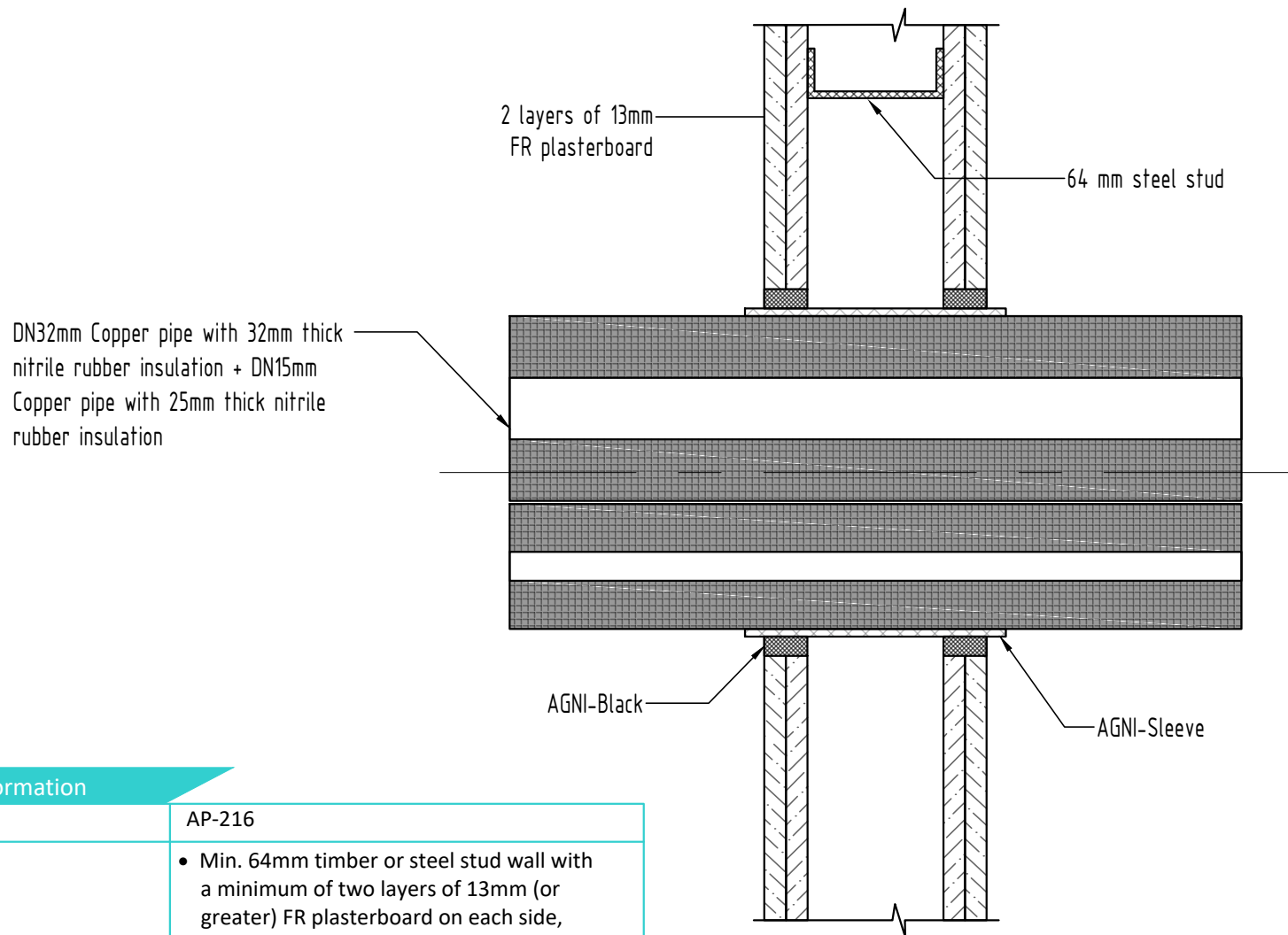

Technical Information

System ID	AP-216
Substrate	<ul style="list-style-type: none"> • Min. 64mm timber or steel stud wall with a minimum of two layers of 13mm (or greater) FR plasterboard on each side, with or without insulation. • Min. 116mm concrete wall
Service range	32mm Copper Pipe with 32mm thick nitrile rubber insulation + 15mm Copper Pipe with 25mm thick nitrile rubber insulation
Annular gap	7.2 - 14.2mm
AGNI-Products	AGNI-Black, AGNI-Sleeve
Protection installation	From both sides of the wall

Compliance Information

Standards	AS1530.4-2014, AS4072.1-2005
FRR/FRL	-/120/120
Reference	PF25008



Agnitek[®]
FIRE RATED TECHNOLOGY

8 Clare St Bayswater
VIC 3153, AUSTRALIA
+61 (03) 7045 4242
info@agnitek.com.au
www.agnitek.com.au

Disclaimer

Agnitek reserves the right to modify product specifications without prior notice due to its ongoing research, development & certification programme. The information in this document is provided in good faith and is intended for guidance purposes only. Any accompanying drawings are solely for illustrative purposes. Since Agnitek cannot oversee installation methods or ensure site conditions, no warranties, expressed or implied, are intended regarding the products' actual performance. We do not accept liability for any loss, damage, or injury from using this information. Please take a look at the test reports displayed on a relevant AGNI-System webpage for all compliance specifics.

Date	12.05.2025
------	------------